

BS 1740 ELBOWS, TEES AND CROSSES, EQUAL

Sockets T

- 1
Nominal bore
Nominale boring
- 6
8
10
15
20
25
32
40
50
65
80
100
125
150

*not appl
*nie van

BS 1740 PLUGS

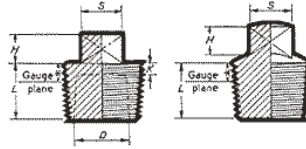

Nominal size		Minimum length of thread for basic gauge length L	Approx size of square S	Minimum effective height of square H	Maximum internal diameter D	Minimum thickness of metal K	Fitting allowance in BS 21 *
in	mm	mm	mm	mm	mm	mm	turns
1/8	6	6.5	6	6			2 3/4
1/4	8	9.7	9	6			2 3/4
3/8	10	10.1	11	10			2 3/4
1/2	15	13.2	13	10			2 3/4
3/4	20	14.5	14	12			2 3/4
1	25	16.8	17	12	22	4	2 3/4
1 1/4	32	19.1	22	16	31	5	2 3/4
1 1/2	40	19.1	27	16	33	5	2 3/4
2	50	23.4	32	19	48	5	3 1/4
2 1/2	65	26.7	37	19	62	6	4
3	80	29.8	37	22	73	8	4
4	100	35.8	46	25	97	10	4 1/2
5	125	40.1	51	29	120	12	5
6	150	40.1	60	32	145	12	5

BS 1740 HEXAGON BUSHES

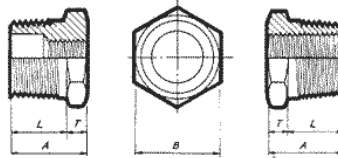

Two types of bush are illustrated, either of which can be supplied

Nominal size		Minimum length of external thread for basic gauge length plus die clearance L	Thickness of hexagon T	Minimum overall length A	Width across flats of hexagon B
in	mm	mm	mm	mm	mm
1/4	8	12.5	6	18.5	14.0
3/8	10	12.5	8	20.5	17.0
1/2	15	17.5	8	25.5	22.0
3/4	20	19.0	10	29.0	27.0
1	25	21.0	10	31.0	36.0
1 1/4	32	24.0	11	35.0	46.0
1 1/2	40	24.0	13	37.0	50.0
2	50	27.0	14	41.0	60.0
2 1/2	65	32.0	16	48.0	78.0
3	80	35.0	19	54.0	90.0
4	100	40.0	22	62.0	115.0
5	125	45.0	25	70.0	140.0
6	150	45.0	25	70.0	166.0

NOTE. Nominal sizes refer to size of male end, i.e. the larger diameter of the bush. The smaller diameter of the bush, i.e. the female end, shall be by arrangement between the manufacturer and the purchaser.